

DATA SHEET

Main properties



Telescopic lip



Pit model for welding



Rated loads up to 60 kN
acc. to EN 1398



Ordering lengths up to
4500 mm



With transit van operating
mode

Dock leveller HTLV4 pit model P

Hydraulic dock leveller, with 3-pronged lip and weight compensation for the choice of loading and unloading of lorries and transit vans. Self-supporting steel articulated design in accordance with EN 1398.

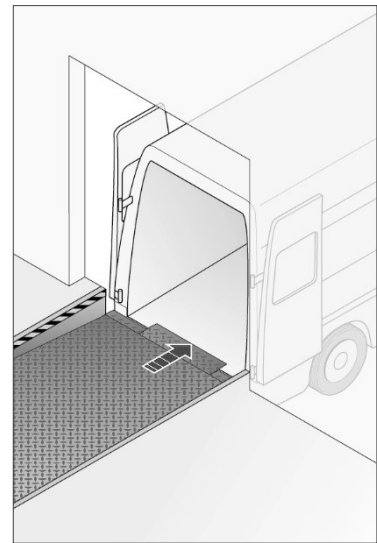
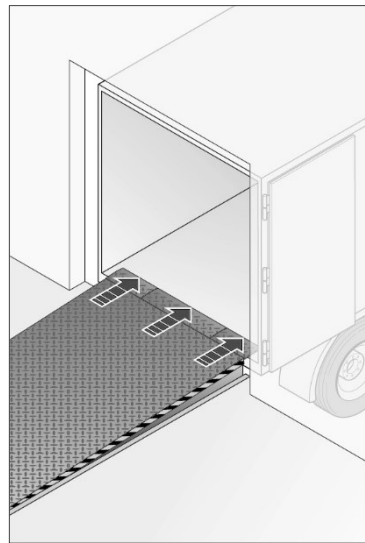

Dimensions (mm)

Ordering width	2000, 2100, 2250			
Ordering length	3000	3500	4000	4500
Installation height	795	795	895	895

Levelling (mm)

Notice: Max. 12.5% gradient / slope in working position acc. to EN 1398.

Telescopic lip 500	A above level	260	340	370	375
	B below level	345	345	400	395
Telescopic lip 1000	A above level	450	510	570	630
	B below level	650	600	720	690

Construction		Standard / option ● / ○		
Design	Dock leveller with torsional flexibility, platform with reinforcement profiles at the bottom side, 3-part telescopic lip with gradient, electrohydraulic system with 2 main cylinders and 2 lip cylinders, self-supporting steel frame, calculation according to the finite elements method			
Safety components acc. to EN 1398	Emergency stop valves, emergency stop switch, restart inhibition, maintenance support, foot guard plates, yellow / black safety markings			
Rated load acc. to EN 1398	60 kN in lorry operating mode, 20 kN in transit van operating mode ●			
Note for forklifts with hard rollers	Restriction of total weight of industrial trucks with PU / Vulkollan rollers recommended to prevent lane grooves in the platform: For reach lift truck max. 4 t			
Platform material	Moulded, anti-slip steel (running plate S235) ●			
Platform material thickness	8/10 mm ●			
Lip material	Moulded, anti-slip steel (running plate S355) ●			
Lip material thickness	15/17 mm			
Lip length	500 mm ●			
	1000 mm ○			
Free overlap length	300 mm ●			
Side segment offset	Up to 500 mm less extended than the centre segment, adjustable ●			
Lip shape	Ordering width (mm)	2000	2100	2250
Type R	Straight	●	○	○
Type S	100 mm chamfering on each side	○	●	●
Segment widths	Side segments	420	420	495
	Centre segment	1090	1190	1190
Gap sealing	Sealing lip, all-round on 3 sides			○
Surfaces		Standard / option ● / ○		
Coating	Steel surfaces sand-blasted, coated with 2-component PUR paint, 60 to 80 µm ●			
	Steel surfaces sand-blasted, galvanized ○			
Paint colour	Traffic black, based on RAL 9017 ●			
	RAL to choose, except for metallic and signal colours ○			
Anti-slip coating	Running plate coated with polyurethane with injected Twaron fibres, approx. 1 – 2 mm thick on the platform and lip, anti-slip class R11 acc. to DIN 51130			○
Acoustic insulation	Running plate coated with polyurethane with injected Twaron fibres, approx. 3 – 4 mm thick on the platform and approx. 1 – 2 mm thick on the lip, anti-slip class R11 acc. to DIN 51130			○

Operator and control		Standard / option	● / ○
Hydraulics temperature range	Suitable for temperatures from -10 to +50°C under the dock leveller		●
	Suitable for temperatures from -25 to +50°C under the dock leveller		○
Motor power	1.5 kW		●
Connecting voltage	400 V / 3-phase		●
Supply frequency	Either 50 or 60 Hz		●
Operator protection category	IP 54		●
Control protection category	IP 65 (jet-water protected)		●
Control elements	Buttons integrated in the housing for separate actuation of the dock leveller and telescopic lip with press-and-hold actuation and "Switch / Return" button for switching between the lorry and transit van operating modes and for automatic return to the loading position		●
Control type	560 V Control with operating mode selection		●
Control equipment			560 V
Standby / error message display	4 × 7-segment display		●
	Automatic impulse return		●
Operation	Convenient telescopic lip operation		●
	Illuminated keyboard		●
	Integrated control button for dock shelter		●
Prepared connections and functions	Wheel chock with sensor		●
	Dock leveller release function		●
	Door release function		●
	Door with automatic operator closing function		○
	Semi-operation		○
	Bluetooth receiver for BlueControl app		●
	HCP bus interface for SmartControl, for example		●
Energy efficiency	Expanded connection options		●
	Energy saving mode		●

Fitting	
Fitting model	Pit model P
Fitting	Fitting by welding in a pit prepared to manufacturer's instructions, with cut-outs on reverse face for an exact weld seam
Protective film	Platform optionally provided with protective film, as standard when equipped with anti-slip coating or acoustic insulation

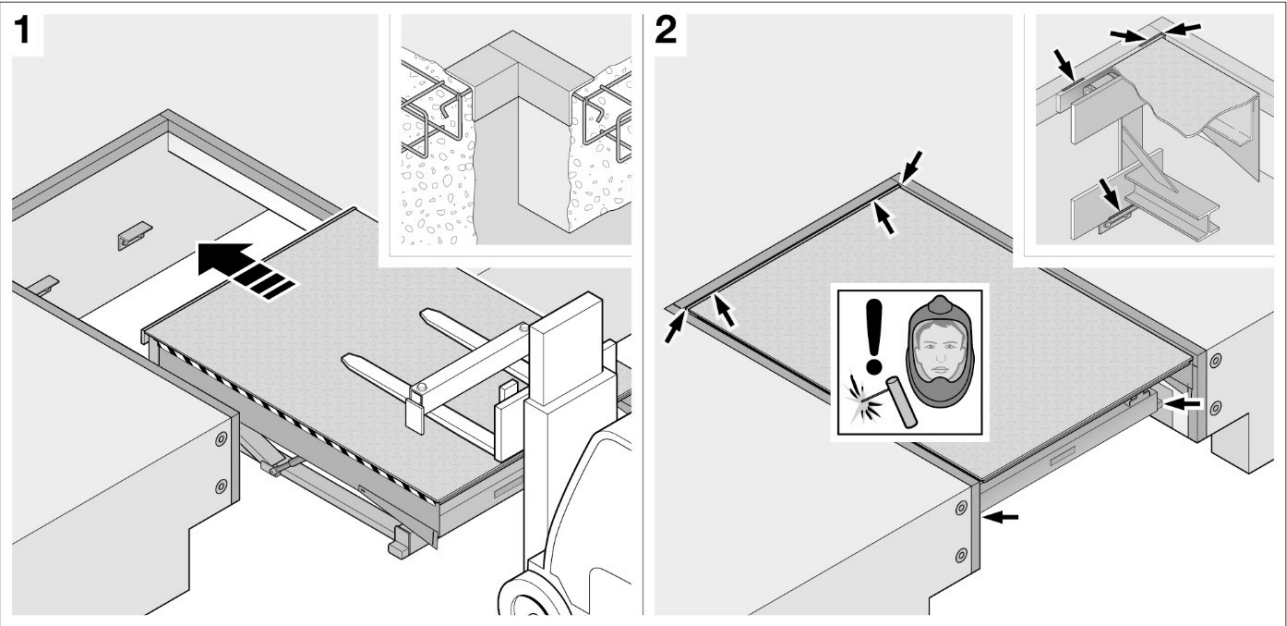

Fitting situation pit model P

The information above, in particular the specifications and illustrations, is not binding and does not constitute an agreement on quality or a guarantee. Changes and errors are expressly reserved. The data sheet is subject to copyright. No part may be reproduced without our prior permission.