

## DATA SHEET

### Main properties



Telescopic lip



Pit model for welding



Rated loads up to 100 kN  
acc. to EN 1398



Ordering lengths up to  
5000 mm

## Dock leveller HTL2 pit model P

Hydraulic dock leveller with telescopic lip. Self-supporting steel articulated design in accordance with EN 1398.

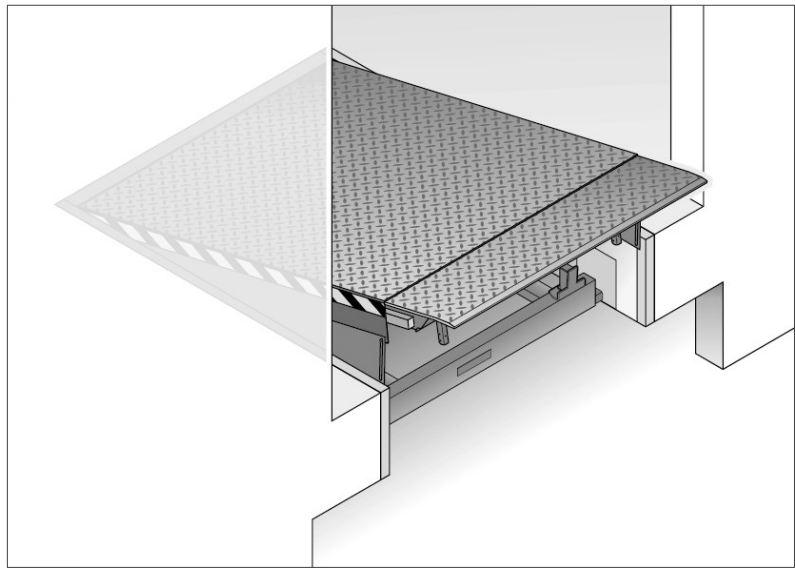

### Dimensions (mm)

Ordering width	2000, 2100, 2250							
	2000	2500	2750	3000	3500	4000	4500	5000
Ordering length								
Installation height	595	595	645	645	745	745	745	745
Special sizes on request								

### Work area (mm) rated load 60 kN / 50 kN

Permissible values up to 12.5% gradient/slope acc. to EN 1398 and with telescopic lip extended. The maximum height adjustment may deviate.

<b>Telescopic lip 500 (60 kN)</b>	A above level	270	340	370	405	470	540	605	670
	B below level	350	345	400	395	425	415	405	400
<b>Telescopic lip 1000 (60 kN)</b>	A above level	325	395	430	460	530	595	660	730
	B below level	410	395	430	420	470	450	440	430
<b>Telescopic lip 1200 (50 kN)</b>	A above level	-	415	450	480	550	615	680	750
	B below level	-	415	450	440	490	470	470	440

### Work area (mm) rated load 100 kN / 83 kN

<b>Telescopic lip 500 (100 kN)</b>	A above level	265	335	365	400	465	535	600	-
	B below level	330	345	385	375	430	420	410	-
<b>Telescopic lip 1000 (100 kN)</b>	A above level	320	395	425	460	520	590	660	-
	B below level	390	400	440	425	480	465	450	-
<b>Telescopic lip 1200 (83 kN)</b>	A above level	-	415	445	480	540	610	680	-
	B below level	-	420	460	445	505	480	465	-

Design		Standard / option		• / ○
<b>Design</b>	Dock leveller with torsional flexibility, platform with reinforcement profiles at the bottom side, telescopic lip with gradient, electrohydraulic system with 2 main cylinders and 1 lip cylinder, self-supporting steel frame, calculation according to the finite elements method			
<b>Safety components acc. to EN 1398</b>	Emergency stop valves, emergency stop switch, restart inhibition, maintenance support, foot guard plates, yellow / black safety markings			
<b>Rated load acc. to EN 1398</b>	60 kN (50 kN with telescopic lip 1200 mm)	●		
	100 kN (83 kN with telescopic lip 1200 mm)	○		
<b>Note for forklifts with hard rollers</b>	Restriction of total weight of industrial trucks with PU / Vulkollan rollers recommended to prevent lane grooves in the platform: For reach lift truck max. 4 t, for industrial truck with rated load ≥ 60 kN max. 6 t			
<b>Platform material</b>	Moulded, anti-slip steel (running plate S235)	●		
<b>Platform material thickness</b>	8/10 mm	●		
<b>Lip material</b>	Moulded, anti-slip steel (running plate S355)	●		
<b>Lip material thickness</b>	12/14 mm with rated load ≤ 60 kN and telescopic lip 500 mm or 1200 mm			
	15/17 mm with rated load > 60 kN or telescopic lip 1000 mm			
<b>Lip length</b>	500 mm	●		
	1000 mm	○		
	1200 mm	○		
<b>Lip shape</b>	Ordering width (mm)	≤ 2000	> 2000	
Type R	Straight	●	○	
Type S	100 mm chamfering on each side	○	●	
Type SG	Segmented (rated load max. 60 kN), Segments approx. 170 mm wide, load bearing capacity up to 600 kg each	○	○	
<b>Gap sealing</b>	Sealing lip, all-round on 3 sides			○
<b>Insulation</b>	30 mm thick insulation layer under the platform; no insulation layer possible in the front area (telescopic lip length + 650 mm)			○
Surfaces		Standard / option		• / ○
<b>Coating</b>	Steel surfaces sand-blasted, coated with 2-component PUR paint, 60 to 80 µm			●
	Steel surfaces sand-blasted, galvanized			○
<b>Paint colour</b>	Traffic black, based on RAL 9017			●
	RAL to choose, except for metallic and signal colours			○
<b>Anti-slip coating</b>	Running plate coated with polyurethane with injected Twaron fibres, approx. 1 – 2 mm thick on the platform and lip, anti-slip class R11 acc. to DIN 51130			○
<b>Acoustic insulation</b>	Running plate coated with polyurethane with injected Twaron fibres, approx. 3 – 4 mm thick on the platform and approx. 1 – 2 mm thick on the lip, anti-slip class R11 acc. to DIN 51130			○

Operator and control		Standard / option	● / ○	
<b>Hydraulics temperature range</b>	Suitable for temperatures from -10 to +50°C under the dock leveller		●	
	Suitable for temperatures from -25 to +50°C under the dock leveller		○	
<b>Drip pan for oil</b>	Drip pan for hydraulic oil, retractable		○	
<b>Motor power</b>	1.1 kW		●	
<b>Connecting voltage</b>	400 V / 3-phase		●	
	230 V / 3-phase		○	
	230 V / 1-phase		○	
	Additional connecting voltages on request		○	
<b>Supply frequency</b>	Either 50 or 60 Hz		●	
<b>Operator protection category</b>	IP 54		●	
<b>Control protection category</b>	IP 65 (jet-water protected)		●	
<b>Control elements</b>	Membrane push buttons integrated in housing for separate actuation of the dock leveller and telescopic lip with press-and-hold actuation and "Auto" button for automatic return to the home position		●	
<b>Control type</b>	420 T Basic control		●	
	420 Ti Combination control with integrated door operation		○	
	460 T Multi-control with extended functions and connections		○	
<b>Control equipment</b>		<b>420 T</b>	<b>420 Ti</b>	<b>460 T</b>
Standby / error message display	LED operation indicator	●	●	
	7-segment display			●
Operation	Automatic impulse return	●	●	●
	Convenient telescopic lip operation	●	●	●
	Integrated control button for dock shelter			●
	Integrated door operation		●	
Prepared connections and functions	Wheel chock with sensor	●	●	●
	Dock leveller release function	●	●	●
	Door release function	○	○	●
	Door with automatic operator closing function			○
	Semi-operation			○
	Expanded connection options			●
Energy efficiency	Energy saving mode	●	●	●

<b>Fitting</b>	
<b>Fitting model</b>	Pit model P
<b>Fitting</b>	Fitting by welding in a pit prepared according to the manufacturer's instructions, or in a steel pedestal, with cut-outs on reverse face for an exact welding seam
<b>Protective film</b>	Platform optionally provided with protective film, as standard when equipped with anti-slip coating or acoustic insulation

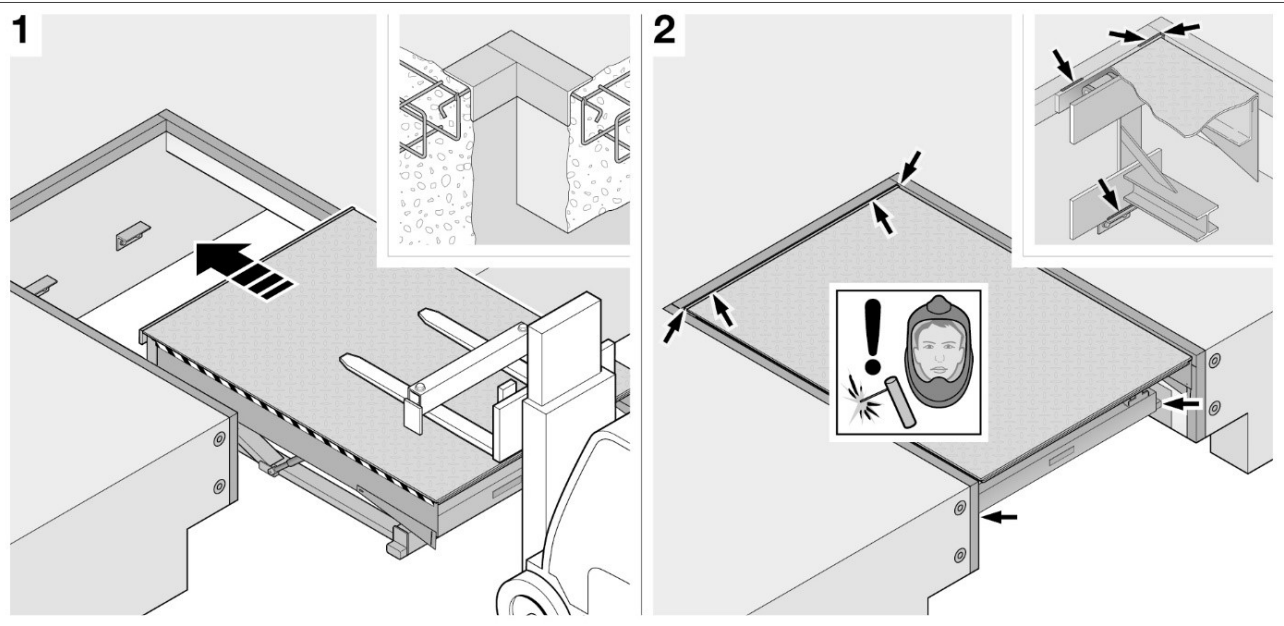

Fitting situation pit model P

The information above, in particular the specifications and illustrations, are not binding and do not constitute an agreement on quality or a guarantee. Changes and errors are expressly reserved. The data sheet is subject to copyright. No part may be reproduced without our prior permission.